

## Existing Layout demarcating BSL 3 Lab, BMHRC Bhopal

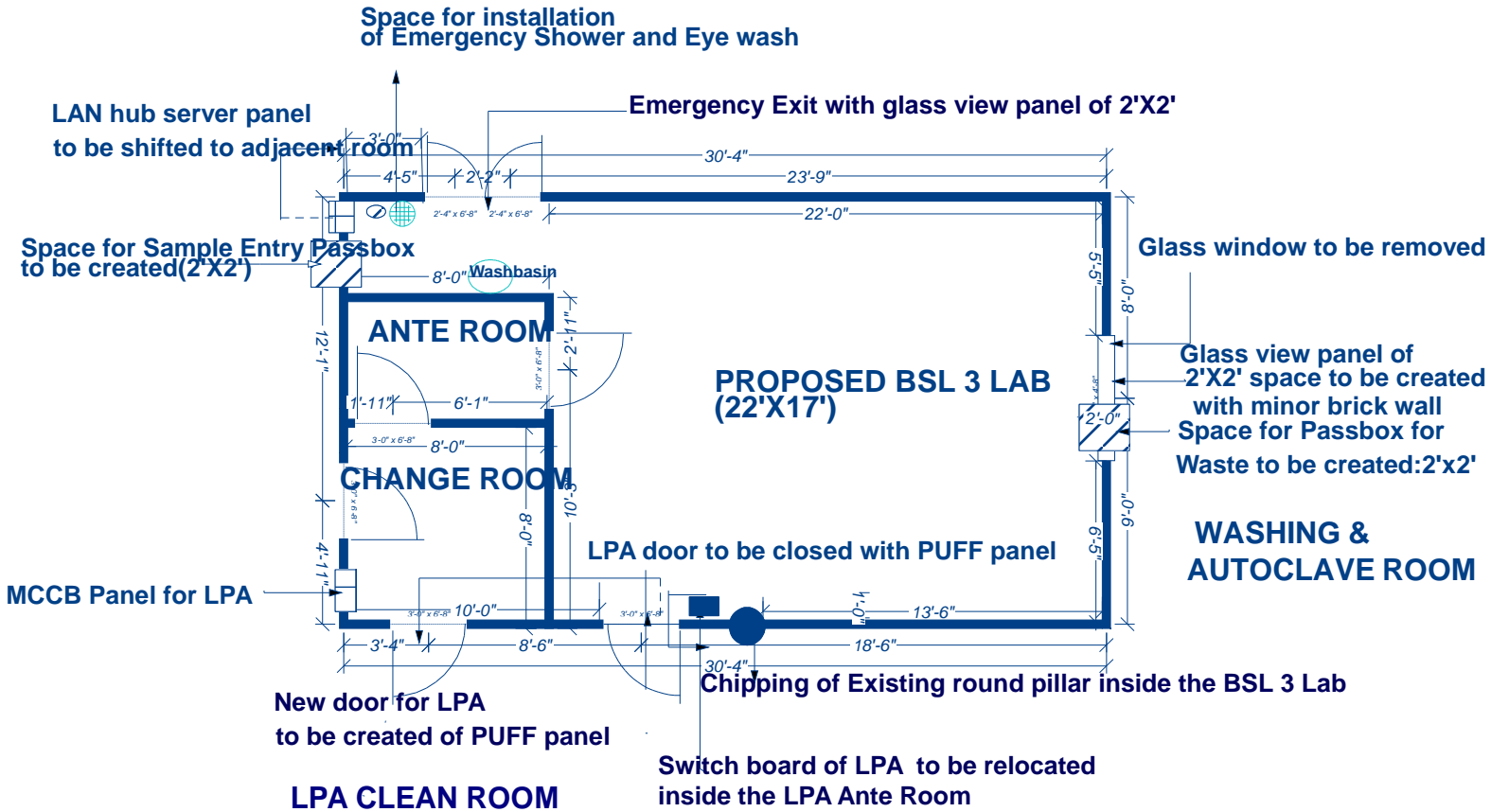

### Activities to be undertaken by BSL 3 Agency appointed by FIND

1. LPA door to be closed with PUFF panel
2. New door for LPA to be created of PUFF panel
3. Switch board of LPA to be relocated inside the LPA Ante Room
4. Chipping of Existing round pillar inside the BSL 3 Lab
5. Emergency Exit with glass view panel of 2'X2'

## Proposed Layout of BSL 3 Lab, BMHRC Bhopal

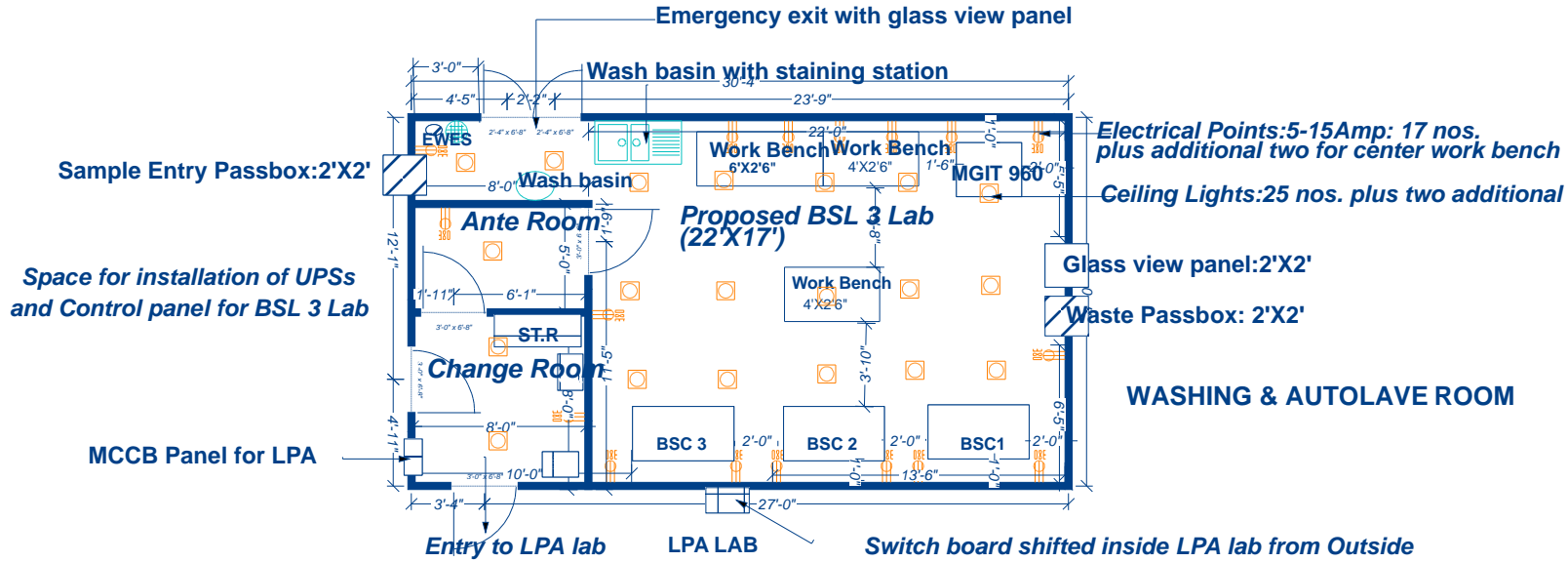

**Dimension:**

- Area of BSL 3 Lab: 22'X17'+8'X4'
- Area of Ante Room: 8'X5'
- Area of Change Room: 8'X8'

**Equipments and other details:**

- BSC: Biosafety Cabinet
- MGIT 960
- ES: Emergency shower
- EW: Eye wash
- Two Passbox: 2'X2' as per layout
- Glass view panel of 2'X2' as per layout
- Wash basin with staining station
- ST.R: Storage Rack
- SR: Shoe Rack
- Work Bench: 4'X2'6" (Two Nos)
- Work Bench: 6'X2'6" (One No.)