

# Existing Lab Layout\_RMRC BHUBANESWAR

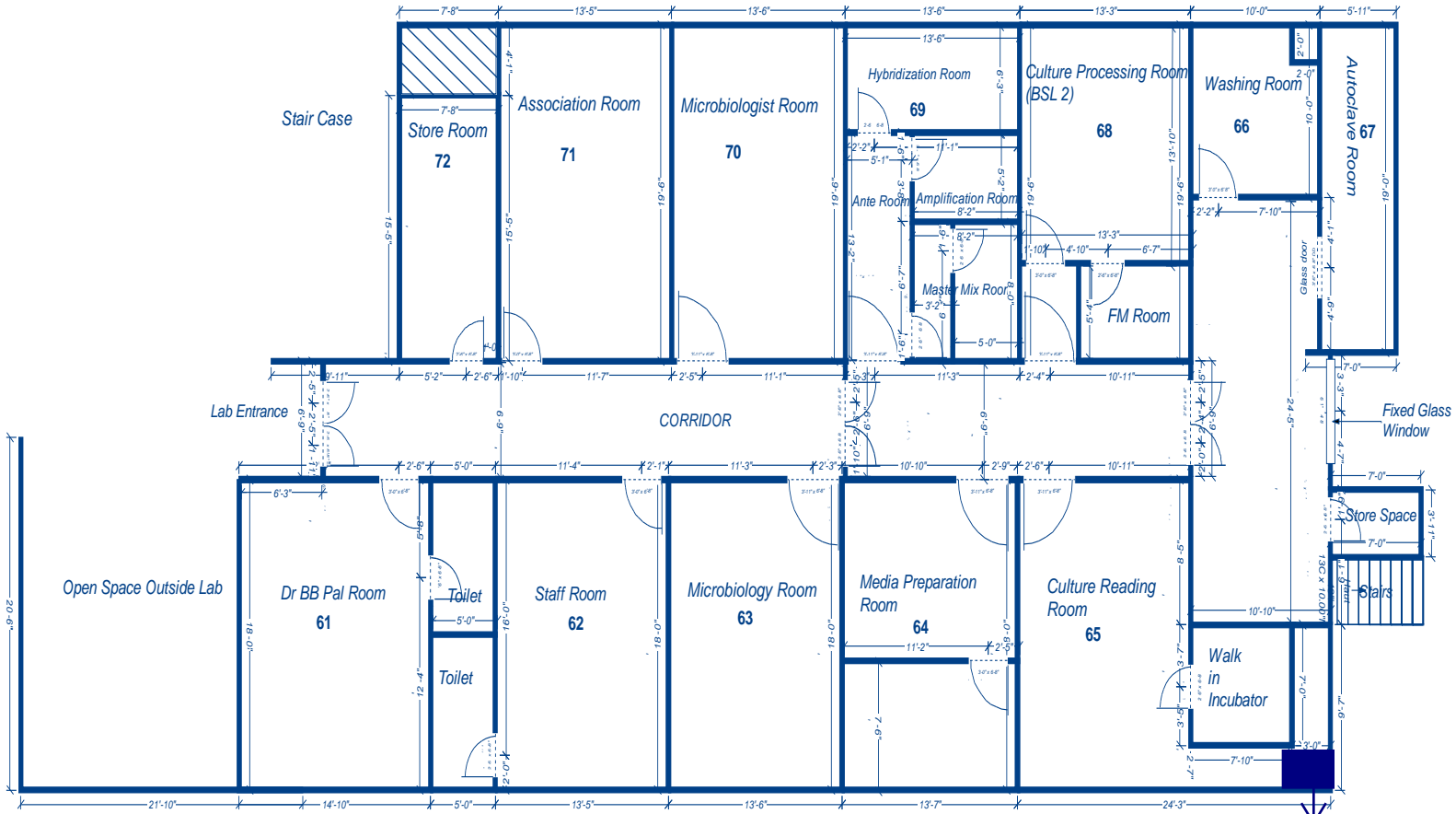

**Room Description;**

- 61: Dr. BB Pal's Room: 18'X14'10"
- 62: Staff Room: 18'X13'5"
- 63: Microbiology Room: 18'X13'6"
- 64: Media Preparation Room: 18'X13'7"
- 65: Culture Reading Room & Walk in Incubator: 24'3"X9'7" + 13'5"X8'5"

- 66: Washing Room: 10'X10'
- 67: Autoclave Room: 19'X5'11"
- 68: Culture Processing Room: 13'10'X13'3"X13'3"X5'4"
- 69: LPA Clean Room: 19'6"X13'6"
- 70: Microbiologist Room: 19'6"X13'6"
- 71: Association Room: 19'6"X13'5"
- 72: Store Room: 15'5"X7'8"

Existing pillar of of 3'4"X2'6"

**Note: EXISTING WINDOW THROUGHOUT THE LENGTH ON BOTH SIDE OF THE BUILDING WINDOW SIZE: 5'5"X7'**

Created with

# Existing Lab Layout demarcating Proposed LPA and BSL 3 Lab\_RMRC BHUBANESWAR

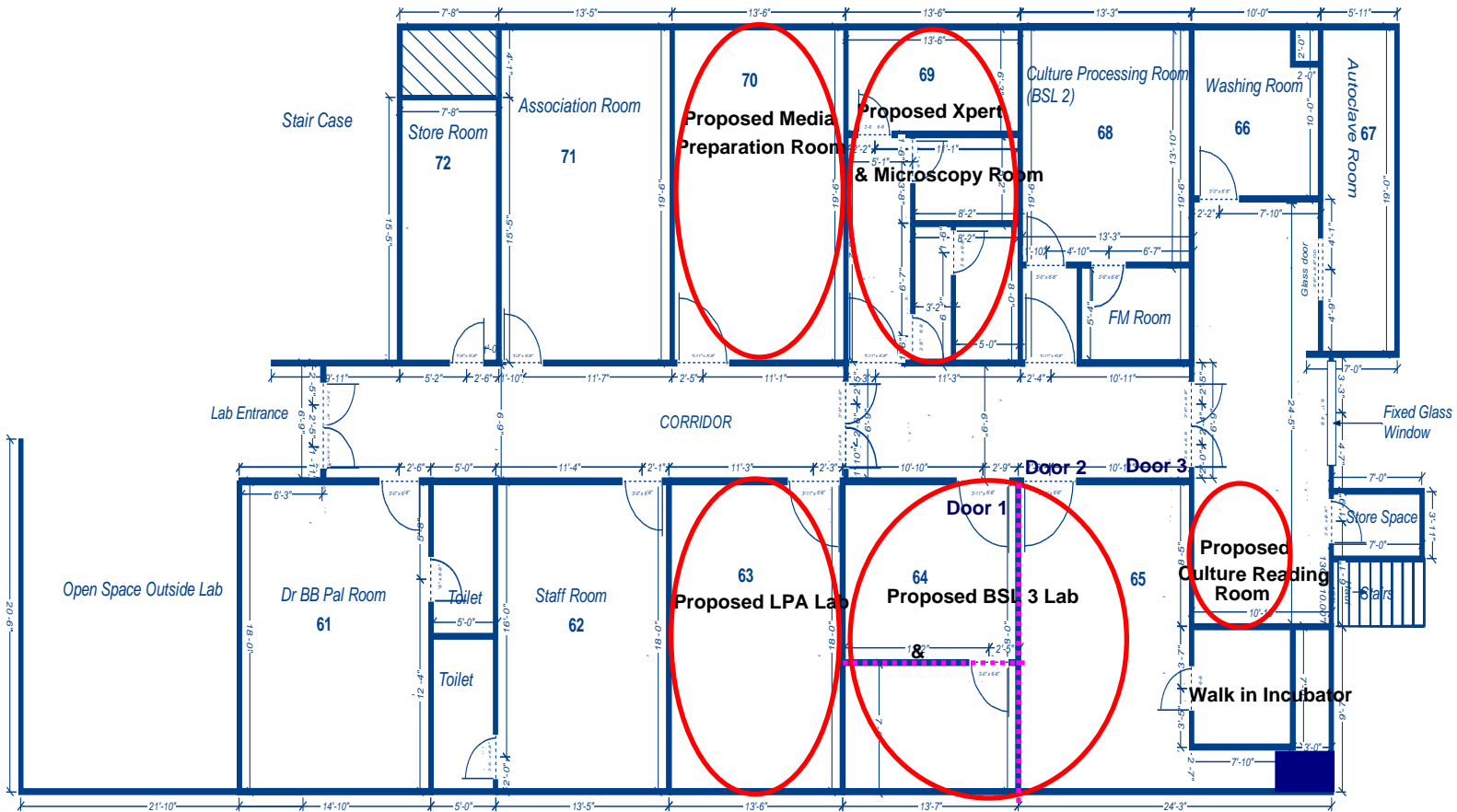

## Room Description;

- 61: Dr. BB Pal's Room: 18'X14'10"
- 62: Staff Room:18'X13'5"
- 63: Proposed Microbiology Room:18'X13'6"
- 64: Proposed BSL 3 Lab:18'3"X18'
- 65: Proposed BSL 3 Lab: 24'3"X9'7"+13'5"X8'5"
- 66: Washing Room:10'X10'
- 67: Autoclave Room:19'X5'11"
- 68: Culture Processing Room:13'10"X13'3"X13'3"X5'4"
- 69: Proposed Xpert & Microscopy Room:19'6"X13'6"
- 70: Proposed Media Preparation Room: 19'6"X13'6"
- 71: Association Room: 19'6"X13'5"
- 72: Store Room: 15'5"X7'8"

Activities to be undertaken by BSL 3 Agency appointed by FIND, refer Annex 2 and 4

1. Removal of Intervening wall between Room No.64 & 65
2. Removal of false ceiling and false wall in Room no. 64
3. Closing of Door 1 with brick wall in Room No. 64
4. Extending the dimension of door 2 in Room No. 65 to 4'X7'
5. Creation and fixing of Aluminum Glass partition door for Door 3 in Room no. 65
6. Culture Reading Room: Dimension: 8'6"X6'":
  - a. Creation of Culture reading room with Aluminum Glass partition including door
  - b. Providing work bench of 7'X2'6".
  - c. Fixing of Light fixture, power outlets and Fan for Culture Reading Room
7. Fixing of view panel of 2'6"X2' in Proposed BSL 3 Lab for Natural light
8. Minor civil work with enamel paint to be done for passage between Proposed BSL 3 lab and Walk in Incubator Room, area of passage: 18'X4'
9. View panel for natural light in Proposed BSL 3 Lab

Note: EXISTING WINDOW THROUGHOUT THE LENGTH ON BOTH SIDE OF THE BUILDING  
WINDOW SIZE: 5'5"X7'

Created with

## Proposed LPA Layout, RMRC Bhubaneswar

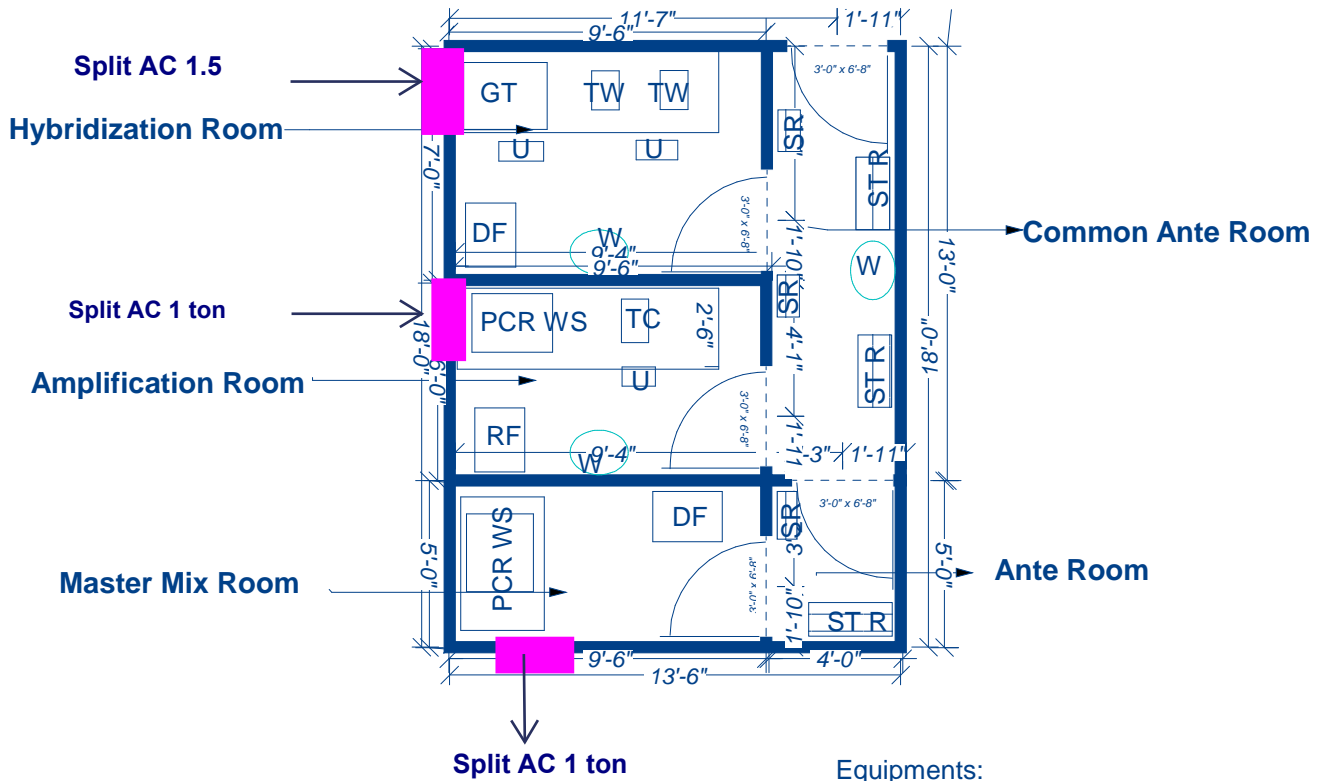

### Dimension:

Total Area of LPA Lab: 18'X13'6"  
 Area of Master Mix Room: 9'6"X5'  
 Area of Ante Room for MM Room: 5'X4'  
 Area of Amplification Room: 9'6"X6'  
 Area of Hybridization Room: 9'6"X7'  
 Area of Common Ante Room: 13'X4'

### Dimension of Work Bench:

Master Mix Room: 4'X2'6"  
 Amplification Room: 8'X2'6"  
 Hybridization Room: 8'X2'6"

Created with

 **nitroPDF** professional

download the free trial online at [nitropdf.com/professional](http://nitropdf.com/professional)

# PROPOSED BSL 3 LAB LAYOUT\_RMRC BHUBANESWAR

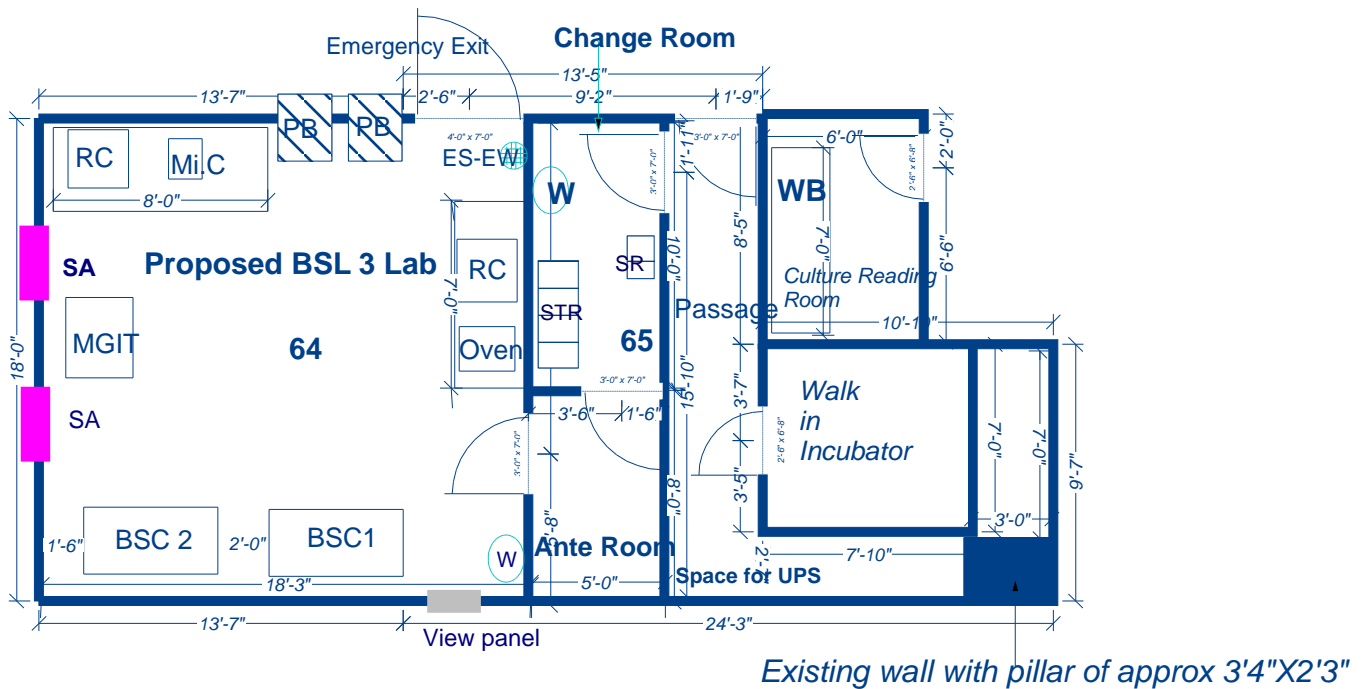

## Dimension:

Area of BSL 3 Lab: 18'X18'5"  
 Area of Change Room: 10'X5'  
 Area of Ante Room: 8'X5'

## Workbench Dimension:

1. 8'X2'6"  
 2. 7'X2'6"

SA: Split ACs: 3.5 ton (2 ton and 1.5 ton each)

## Equipment

BSC: Biosafety cabinet  
 MGIT: MGIT 960  
 RC: Refrigerated Centrifuge  
 Mi.C: Microliter Centrifuge  
 Oven  
 ES: Emergency Shower  
 EW: Eye wash  
 PB: Passbox: 2'6"X2'(2 Nos.)  
 U: UPS  
 STR: Storage Rack  
 SR: Shoe Rack  
 W: Wash Basin  
 WB: Work Bench

Created with

nitroPDF professional

download the free trial online at [nitropdf.com/professional](http://nitropdf.com/professional)