

Project Name: Design, Construction, Testing, Commissioning and Validation of TB Containment Laboratories and Associated Works on 'Turnkey Basis' under Revised National Tuberculosis Control Programme (RNTCP) across India

Amendment No.- 01

Dated: - 03/11/2018

- I. IFB No. :- SAMSPL/18-19/ET/2
 II. Date of Publication / Notification :- 18/10/2018

Reference original ATI published on 18th October, 2018, following amendment is issued (applicable at all relevant sections of ATI)

1. Extension of date of bid submission and opening of technical bids:

Ref of ATI	Existing (For)	As amended (Read as)
Cover Page		
Last Date, Time and Place for receipt of Bids	20th November, 2018 till 1430 hours at Strategic Alliance Management Services Pvt. Ltd. B01-B03, Vardhman Diamond Plaza, Community Centre, D. B. Gupta Road, Paharganj, New Delhi - 110055	27th November, 2018 till 1430 hours at Strategic Alliance Management Services Pvt. Ltd B01-B03, Vardhman Diamond Plaza, Community Centre, D. B. Gupta Road, Paharganj, New Delhi - 110055
Date, Time and Place for opening of Technical bids	20th November, 2018 till 1500 hours at Strategic Alliance Management Services Pvt. Ltd. B01-B03, Vardhman Diamond Plaza, Community Centre, D. B. Gupta Road, Paharganj, New Delhi - 110055	27th November, 2018 till 1500 hours at Strategic Alliance Management Services Pvt. Ltd B01-B03, Vardhman Diamond Plaza, Community Centre, D. B. Gupta Road, Paharganj, New Delhi - 110055

2. ADDITION OF ONE MORE LAB FOR UP-GRADATION WORKS: Details of 10th lab added in the Tender

3. SECTION- I: INSTRUCTIONS TO BIDDERS (ITB)

a. Clause no. 17. EARNEST MONEY DEPOSIT (EMD)

Schedule No.	Name of Laboratory for Up-gradation Works	Amount of EMD (INR)
X	Guru Gobind Singh Medical College, Sadiq road, Faridkot, Punjab	1,00,000/-

4. TECHNICAL EVALUATION CRITERIA OF BID

a. ASSESSMENT OF QUALIFICATION (Refer ITB para 27 A.)

- (b) The bidder or Bidder and their consortium partner(s) (as the case may be) together should have experience of successfully and satisfactorily executing **similar works*** during last seven years (as on date of opening of technical bids) as specified below;

Eligibility for (Number of schedules quoted)	Minimum similar work experience (No. of similar works/Labs)
One or Two	Two
Three	Three
Four	Four
Five	Five
Six	Six
Seven	Seven
Eight	Ten
Nine	Twelve
Ten	Fourteen

***Similar works shall mean successful construction, testing, commissioning and validation of Bio-Safety laboratory (BSL-2/ BSL-2+/ BSL-3/BSL-4 laboratories)/ Biomedical research facility/vaccine facility including Internal construction works, electrical works, HVAC works, Access Control System etc.**

5. Price Bid Form for Schedule-X (Faridkot)

Form FIN-3: Priced Bill of Quantity

(To be submitted for each quoted Schedule with Price bid only)

Bidders shall submit detailed workings of Lump Sum Contract Price (Component-A & B as given in FIN-2) for Design, Construction, Testing, Commissioning and Validation of TB Containment Laboratory and associated works on 'Turnkey Basis'. The total price mentioned in the table below should coincide with the Price Component A & B as given in FIN-2 for each Schedule.

Schedule X:- Faridkot, Punjab

Sl. No.	Item description	UNIT of Measurement	Quantity	Unit Price (inclusive of all applicable taxes)	Total Price (inclusive of all applicable taxes)
HVAC					
1	Thermal Insulation for Ducting				
2	Ducting				
3	Containment HEPA Filter (H14) Housing with Test elbow port				
4	Diffusers, Grills				
5	Airtight and Gastight Isolation Dampers				
6	VAV, Dampers (VCDs, Low Leakage dampers)				
7	Fire Dampers				
8	Magnehelic Gauge				
9	HEPA filter with BIBO Indigenous with Test elbow port				
11	AHU and Ventilation Units				
12	AHU Filters (G4, F7)				
13	AHU Fan/Blower				
14	Motor				
15	Condensing Unit				
16	compatible cooling coil				
17	HVAC Control Valves				
18	VFD				
19	MS Structural for AHU Shed				
20	BSC ducting with Exhaust blower (Damper, Pipe, other ducting accessories material and foundation work for Exhaust blower)				

Sl. No.	Item description	UNIT of Measurement	Quantity	Unit Price (inclusive of all applicable taxes)	Total Price (inclusive of all applicable taxes)
Electrical Panel, AHU Control Panel, Electrical Cabling & accessories					
1	LT Switch Gears (ACB, MCCB, MCB, ELCB, RCCB, Contactors, SFUs)				
2	FUSE				
3	Protection Relays				
4	Selector Switches				
5	Ammeters, Voltmeters				
6	Indication Lamps (LED Type)				
7	Push Buttons				
8	PF Meters				
9	Energy Meter				
10	Electric Multifunction Meter				
11	Load Managers				
12	Current Transformers				
13	Modular Switches, Socket outlets, Ceiling lights				
14	PVC Conduits, Accessories (running meter)				
15	Copper wires				
16	XLPE Insulated armoured wire				
17	UPS- 3KVA 30 minutes backup				
18	Distribution Board				
19	CONTROL JUNCTION BOXES				
Interiors					
1	Modular Material for Ceiling				
2	Modular Material for wall panels with coving				
3	Epoxy Flooring				
4	Modular (PUFF panel) Flush Doors				
5	CCTV Camera				
6	LED Monitor				
7	Fire Alarm system with Fire extinguishers				
8	Addressable analogue main panel				
9	Smoke Detectors				
10	Emergency eye wash and Shower				
11	Pass Box				
12	Split ACs with Accessories with change over timer				
13	Data Cable (CATFI Cable connection point)				

Sl. No.	Item description	UNIT of Measurement	Quantity	Unit Price (inclusive of all applicable taxes)	Total Price (inclusive of all applicable taxes)
14	Door interlocking & access control system				
15	Temperature sensor, transmitter & display				
16	Humidity sensor, transmitter & display				
17	Pressure sensor & display				
18	EPABX Box				
19	Telephone set, Co-axial wires & cables				
20	Laboratory Stools				
21	SS Trolley				
22	SS Workbench				
23	SS Shoe Racks				
24	Wash Basin				
25	Garment Cubicles				
26	RTV Silicon Sealant				
27	Validation of Lab & BSC				
27	Misc. Civil & Plumbing Work including AHU foundation				
28	Dedicated Earthing				
29	Site specific additional work				
30	Any other items as quoted by the bidder				

Note: Bidder may include any important item/s missed from the above list and site-specific work requirement associated with TB Containment Lab up-gradation

6. Schedule of Requirement, Technical Specifications and Drawings/ Layouts Of Laboratories and Required additional Works FOR NEW LAB (REFER SECTION-IV OF BID)

a. schedule of Requirement

Schedule No.	Brief Scope of Works and List of Sites
	Design, Construction, Testing, Commissioning and Validation of TB Containment Laboratory and associated works with two years of Comprehensive warranty period on 'Turnkey Basis' in compliance with Revised National Tuberculosis Control Programme (RNTCP), Central TB Division(CTD), Govt of India (GoI) and the cost of maintenance of laboratories for the period of 3 years after warranty period at following additional site:
X	Guru Gobind Singh Medical College, Sadiq road, Faridkot, Punjab

b. **Schedule for Completion and Handover of Works:** Within six (06) months of issuance of Notification of Award (NOA) for each quoted Schedule.

c. Detailed address of site:

Address	consignee's representative	Tel / Mobile	Email	Alternate Staff Officer	Mobile	Alternate Staff Email
Guru Gobind Singh Medical College, Sadiq road, Faridkot Punjab-151204	Dr. Neerja Jindal Professor & Head, Microbiology Department, GGSMC Faridkot, 2 nd Floor	9417691818	idspmcfaridkot@yahoo.com neerjarajender@hotmail.com	Dr. Shilpa Arora, Assistant Professor Department of Microbiology Dr. Vishal Sharma, Associate Professor, Department of Microbiology	9988885091 9501323322	s.arora49@yahoo.com vsqmcs@gmail.com

D. SCOPE OF WORK AND TECHNICAL SPECIFICATIONS OF THE UPGRADATION WORKS OF THE ADDED LAB WILL BE AS PER SECTION IV. D.

e. **SCOPE OF WORKS FOR ADDITIONAL WORK REQUIREMENT AND SOME SITE-SPECIFIC DETAIL FOR TB CONTAINMENT LAB UP-GRADATION WORK**

**Additional work requirement and some site-specific detail for TB containment lab up-gradation work
Please refer to lab layouts for clarity on below requirements (Please refer to lab layouts for clarity on below requirements):**

Name of Lab	Specific work requirement
GGSMC, Faridkot	<p>Additional Civil, Plumbing and Electrical work in Pathology Seminar Room and Biochemistry Store Room - for creating TB Containment Lab and Washing cum Autoclave equipment</p> <p>1. For Proposed TB Containment Lab</p> <ol style="list-style-type: none"> a. Permanent closing of two existing window of size [5' 10" X 5'10"] by brick & cement. The window facing towards the corridor needs to be reduce for viewing purpose as indicated in the layout. b. Removal of existing electrical fixtures (fan, electrical point & ceiling lights) from the proposed TB Containment Room and hand over to institute. c. Removal of existing False ceiling from inside the proposed TB Containment lab. d. The existing tile flooring is not good and observed damages in the flooring.so the entire tile flooring required. The area of tile flooring is 26' x 19' approx. 494 Sqft area. e. The existing entry door to the proposed TB Containment lab needs to convert to the emergency exit door as per specification and layout and the remaining space needs to be close permanently by brick & cement with smooth painting. f. The existing entry door to the proposed change room needs to be reduced as indicated in the layout and the remaining space needs to be permanently close by brick & cement. <p>2. For creating Washing cum Autoclave Room (as indicated in layout):</p> <ol style="list-style-type: none"> a. Creation of entry Door of size (4' width and 6'8" height) with lock & key facility to the proposed Autoclave cum washing Room as indicated in the layout. b. Creation of aluminum partition of size 14' L and 7' W to cover the entire ante room and change room. c. The existing tile flooring is not good and observed damages in the flooring.so the entire tile flooring required. The area of tile flooring is 26' x 19' approx. 494 Sqft area. d. White wash & painting of entire room of area approx. 494 Sqft. e. Removal of existing electrical fixtures (fan, electrical point & ceiling lights) from the proposed TB Containment Room and hand over to institute f. Removal of existing False ceiling from inside the proposed Change & Ante Room and Washing cum Autoclave Room. g. Supply & Installation of one 32 AMP, single phase MCB socket with required wiring for one vertical autoclave h. Supply & Installation of one 4 Pole MCB with 40 A 3 phase with one neutral and ground for one Horizontal Autoclave i. Plumbing work for installation of Horizontal Autoclave.

	<ul style="list-style-type: none">j. Supply & installation of Five 15/6 AMP, single phase electrical socket with wiring as per layoutk. Creation of one work bench with granite top and two modular wash basins of dimension 16'(L) X 3'(W) as indicated in the layout (WB4) (wash basins and their fitting be chemical resistant)l. Supply & installation of 6 Ceiling lights & 2 ceiling fan with dedicated on/off switchm. Supply & Installation of one exhaust fan with necessary wiring with dedicated on/off switch
--	--

General Work Requirement:

- Batteries of UPS should be provided with rack. UPSs with batteries should be installed and well-arranged/organized well giving aesthetic look
- Dedicated earthing to be done for TB Containment Lab

f. Area Details of TB Containment Lab

Sch. No.	Name of the Site	Lab Location	TB Containment Lab		Ante Room		Change Room		Total Area(D+F+H)	No. of BSC to be installed	No. of Trolley	Capacity of split AC *		Total quantity of AC	Location of AHU
			Dimensions	Area(sq.ft.)	Dimensions	Area(sq.ft.)	Dimensions	Area(sq.ft.)				1.5 TR	2 TR		
10	GGSMC, Faridkot	2 nd Floor	26' X 19'	494	6'6" X 7'	46	7'6" X 7'	53	593	3	4 (3 Two tier trolleys for each BSC +1 trolley with lid for transportation of material from lab to the Autoclave room		2 TR	2	on the roof top of 3 rd floor(Terrace) parallel to the proposed TB Containment Room(2 nd Floor)

* Back up split AC for after work hours support for MGIT

g. Power requirement

Sl. No.	Equipment	Quantity	Power Requirement (W) Approx	Dimension (Feet & Inch) L X H X D	Weight (Kg)	Remarks	Placement
1	Biosafety Cabinet(with external blower)	2/3*	2000	4'4" x 7'3" x 2'6"	225	Thimble ducting	Floor Standing
2	Refrigerated centrifuge with UPS	1/2/3*	1800	2' x 1'3" x 2'3"	120		Benchtop
3	MGIT	1	1560	2'6" x 4'6" x 3	500		Floor Standing
4	Printer for MGIT	1	50	1'3" x 1'6" x 1'7"	NA		Floor Standing
5	Vortex	2/3***	30	0.4" x 0.4" x 0.6"	3		Benchtop
6	Refrigerator	1	500	2'1" x 2' x 4'	52		Floor Standing
7	Electric Micro Incinerator	2/3***	1000	0.4' x 0.6' x 0.6'	2		Benchtop
8	Split AC	2/3**	2000-3500	3'2" x 1' x 1'	15	Depends on Manufacturer	Wall Mounted

Note
 * As per Layout
 ** Per Equipment
 *** Per BSC

h. Lab Layout/ Drawings (Sch. No. X – Faridkot)

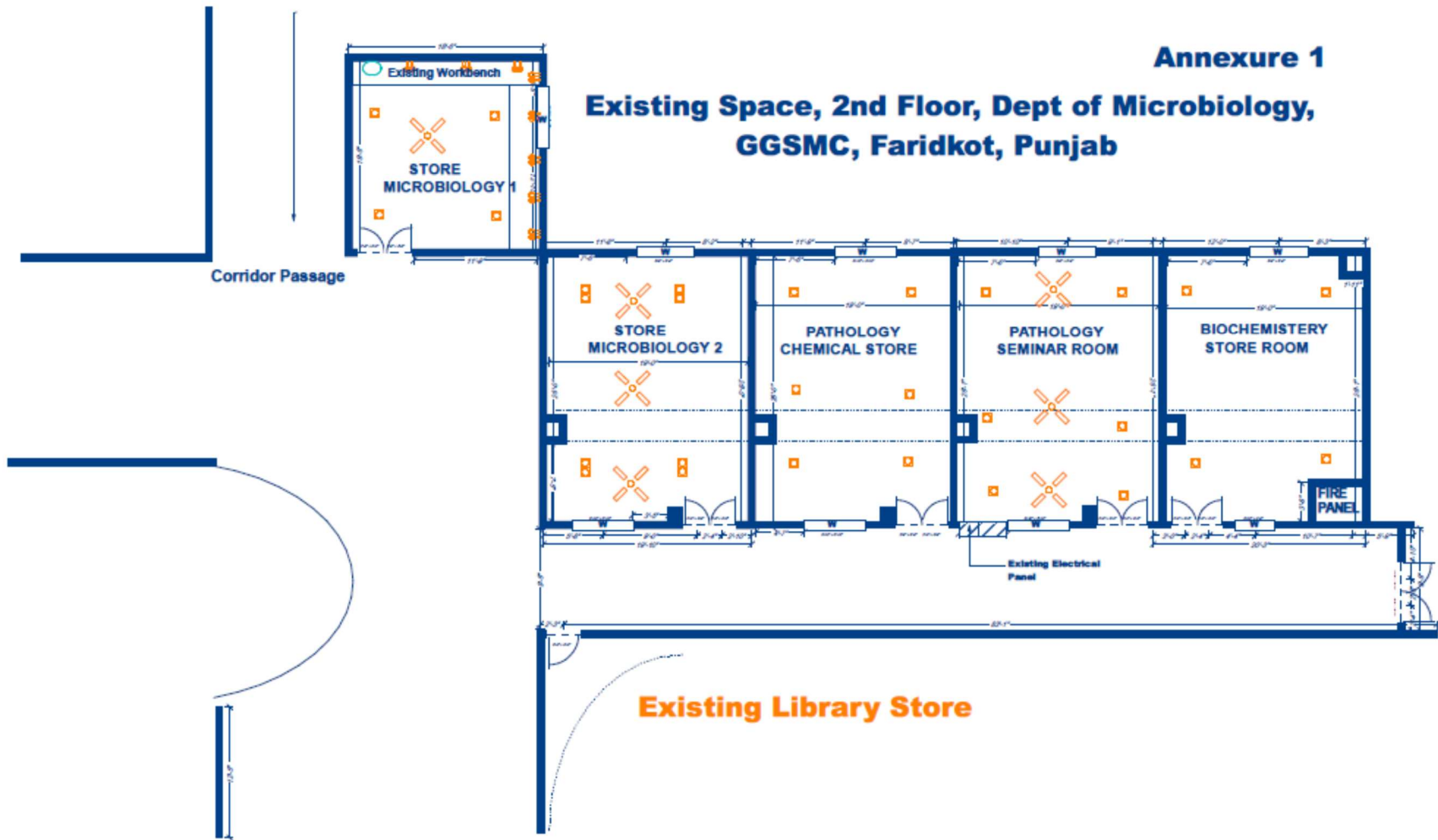

Annexure 2

Proposed Sections of TB C& DST Lab, 2nd Floor, Dept of Microbiology, GGSMC, Faridkot, Punjab

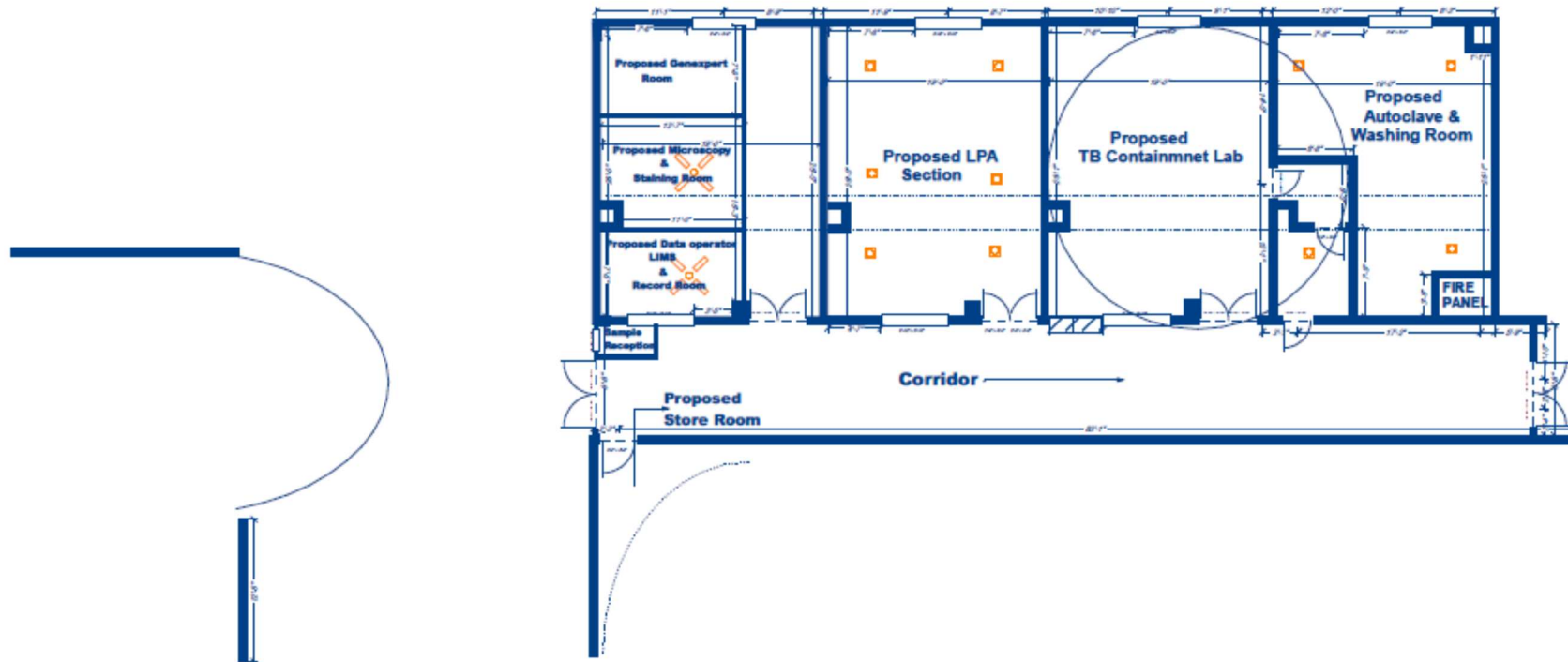

Annexure 3

Proposed TB Containment Lab, Autoclave & washing Room 2nd Floor, Dept of Microbiology, GGSMC, Faridkot, Punjab

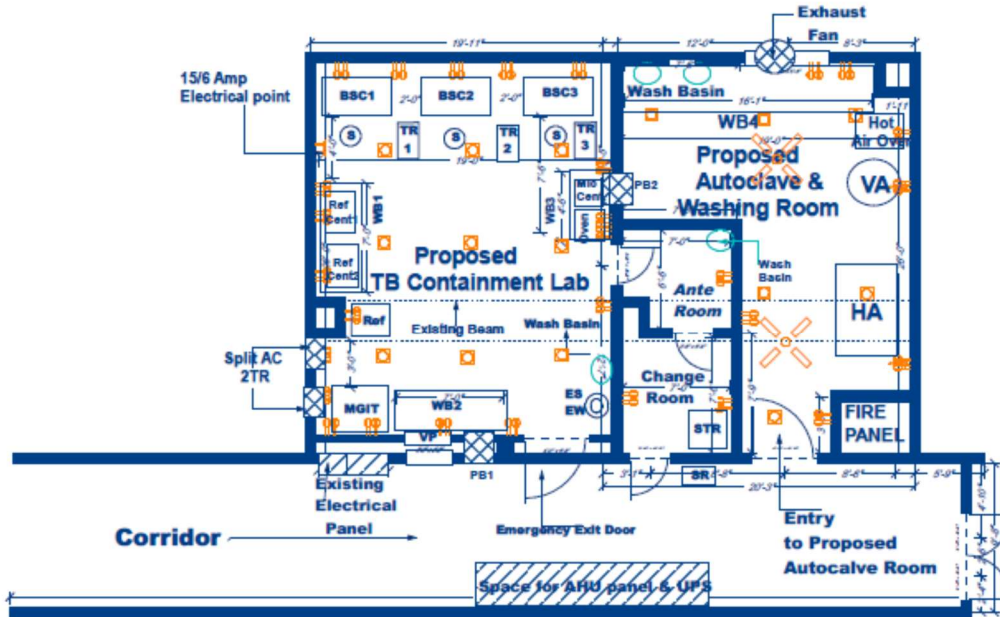

Equipment Details:

BSC: Bio-safety Cabinet (3 nos.)
 RF: Refrigerator (1 nos.)
 Ref. Cent: Refrigerated Centrifuge (2 nos.)
 SA: Split AC (2 Tr) (2 nos.)
 MGIT: MGIT 960 (1 nos.)
 VA: Vertical Autoclave
 HA: Horizontal Autoclave

PB: Pass box (2'x2') 2 nos.)
 WB1: Work Bench1 (LxWxH)(7'x3'x2'6")
 WB2: Work Bench2 (LxWxH)(7'x3'x2'6")
 WB3: Work Bench3 (LxWxH)(4'6"x3'x2'6")
 STR: Storage cabinet (LxWxH)(2'6"x1'6"x4")
 ES & EW: Emergency Shower and Eye Wash.
 TR: Trolley (2'x1'6") :4 nos
 S: Revolving Stools (5 nos.)
 SR: Shoe Rack (2'x1')
 VP: View Panel(1 no)

Internal Dimensions:

1. Change Room: 7'6" X 7'
2. Ante Room: 6'6" X 7'
3. TB containment Room: 26' X 19'

The Internal ceiling Height to be kept 9'
 from the floor .Floor to beam height is 12'3".

Note:

Space for AHU placement is identified on the roof top of 3rd Floor(Terrace)
 parallel to the proposed TB Containment Room(2nd Floor).
 Proper Platform needs to be created for AHU Placement

The above amendment is integral part of the original ATI and shall be applicable to all relevant sections of the referred ATI. Kindly prepare and submit your bids accordingly.

For Strategic Alliance Management Services Pvt. Ltd.

Jyoti Singh
 Sr. Manager (Procurement)